

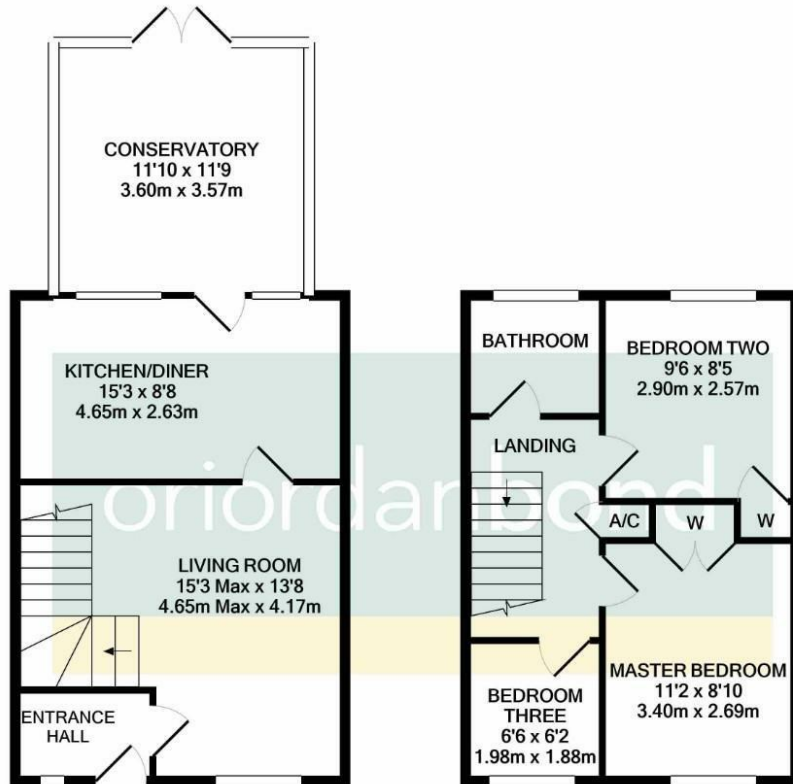

15 Hedgeway

East Hunsbury, Northampton

oriordanbond

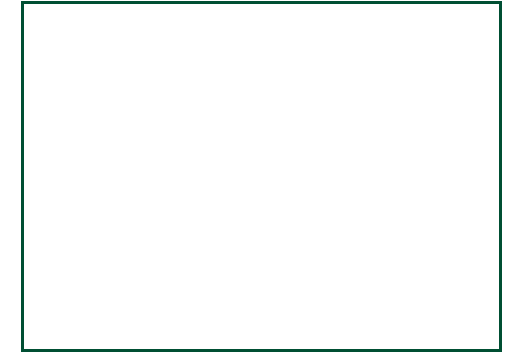
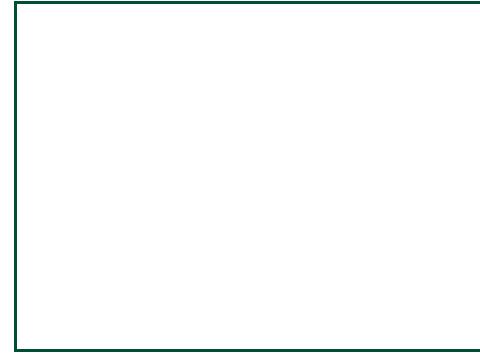
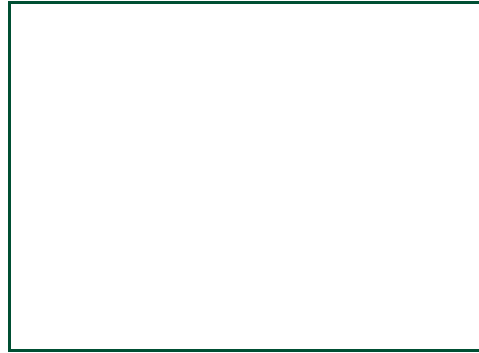

GROUND FLOOR
APPROX. FLOOR
AREA 481 SQ.FT.
(44.7 SQ.M.)

1ST FLOOR
APPROX. FLOOR
AREA 343 SQ.FT.
(31.8 SQ.M.)

TOTAL APPROX. FLOOR AREA 823 SQ.FT. (76.5 SQ.M.)

Whilst every attempt has been made to ensure the accuracy of the floor plan contained here, measurements of doors, windows, rooms and any other items are approximate and no responsibility is taken for any error, omission, or mis-statement. This plan is for illustrative purposes only and should be used as such by any prospective purchaser. The services, systems and appliances shown have not been tested and no guarantee as to their operability or efficiency can be given
Made with Metropix ©2021

15 Hedgeway

East Hunsbury

Northampton NN4 0SP

GUIDE PRICE £200,000

An end of terrace property, located within the heart of East Hunsbury, offered for sale with no upper chain.

Accommodation comprises entrance hall, sitting room, kitchen/dining room, conservatory, three bedrooms and a family bathroom. Outside to the front is off road parking leading to a garage and to the rear is an enclosed garden. Further benefits include uPVC double glazing and gas radiator heating. (D/685/M)

Additional information

- Council Tax Band: C
- Energy Efficiency Rating: D

Viewing

Viewing strictly by appointment – details below

Disclaimer

O’Riordan Bond Estate Agents Limited has not tested apparatus, equipment, fittings or services and so cannot verify they are in working order. The buyer is advised to obtain verification from their solicitor or surveyor.

O’Riordan Bond Hunsbury Sales

01604 706007

hunsbury@oriordanbond.co.uk

